



MONSIEUR TRICOT
HANGING LAMP

User manual English US

Version 7 - 02-2025

TRIBÙ

CONTENTS

Introduction	4	Product overview hanging lamps	11
		Parts list	11
The story of Monsieur Tricot	4	Specifications	12
Collection overview	5	Installation	13
Safety instructions	7	Check the contents of the package	13
		Installing the lamp	13
Intended use	8	Maintenance	16
Disclaimer	8	Replacing the LED light bulb	16
		Cleaning the cover	18
Recycling	8	Notes	22
Compliance	9		

INTRODUCTION

Congratulations on the purchase of your Monsieur Tricot lamp. Its warm glow and hand-crocheted or knitted fabric will cast beautiful shadows as a magical backdrop for long, cosy summer nights. The Monsieur Tricot hanging and standing lamps form a complete family of lights – you can read their story below.

This user manual contains all the necessary information for the correct, efficient and safe use of your lamp. We encourage you to read this information carefully before installing or using the product.

One lamp from the Monsieur Tricot collection has been used as an example to explain the instructions. It may be possible that your lamp looks slightly different.

THE STORY OF MONSIEUR TRICOT

Designer Ilia Eckardt grew up immersed in the Belgian fashion scene, his mother Hilde Frunt knitting prototypes for Belgian fashion designers such as Raf Simons, Ann Demeulemeester and Dries Van Noten. Fascinated by their world, Ilia worked on several knitting projects of his own, experimenting with innovative knitting techniques and materials.

Monsieur Tricot is his first creation, a family of in- and outdoor lamps, knitted or hand-crocheted with an innovative, weatherproof yarn. The sphere shaped lights give a warm glow and the different patterns cast beautiful shadows. The knitting and crocheting is done in Belgium by a network of artisans and every item is checked by Ilia and his mother.

As family is very important to the designer, he created his light objects as a family. Meet the handsome Monsieur Lebonnet, the graceful Madame Latoque, the chic Madame Cachet and their nephew Monsieur Ellipse.

COLLECTION OVERVIEW

COLORS

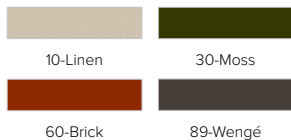

HANGING LAMPS

Monsieur Lebonnet



dia 30 cm
D080130H



dia 40 cm
D080140H



dia 60 cm
D080160H

Madame Latoque



dia 30 cm
D080230H



dia 40 cm
D080240H

Madame Cachet



dia 30 cm
D080330H



dia 40 cm
D080340H



dia 50 cm
D080350H

Monsieur Ellipse



dia 40 cm
D080440H

STANDING LAMPS

Monsieur Lebonnet



dia 30 cm
D080130S



dia 40 cm
D080140S

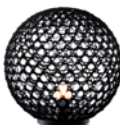

dia 60 cm
D080160S

Madame Latoque



dia 30 cm
D080230S



dia 40 cm
D080240S

Madame Cachet



dia 30 cm
D080330S



dia 40 cm
D080340S



dia 50 cm
D080350S

Monsieur Lebonnet



dia 30 cm
D081130SW



dia 40 cm
D081140SW



dia 60 cm
D081160SW

Madame Latoque



dia 30 cm
D081230SW



dia 40 cm
D081240SW

Madame Cachet



dia 30 cm
D081330SW



dia 40 cm
D081340SW



dia 50 cm
D081350SW

SAFETY INSTRUCTIONS

GENERAL

- ⚠ Only use the product as described in this manual.
- ⚠ Do not use a damaged product.
- ⚠ Do not drop the product, avoid bumping, and avoid impact with hard, pointy objects.
- ⚠ Do not use the product if a part is damaged or defective.
Replace a damaged or defective part immediately
- ⚠ Do not tumble dry the removable cover.
- ⚠ Any changes made to the product can have consequences for safety, correct operation and warranty procedures.
- ⚠ Every lamp must be removed at least 2 meter horizontally and vertically from any type of heat source.
- ⚠ Do not submerge the product in water or any other liquid.
- ⚠ Do not unscrew the screws of the product and never open the product to avoid damage.
- ⚠ Always switch off the power before starting installation or maintenance work.

INTENDED USE

The product is only intended as indoor or outdoor LED lighting. Any change to the product can have consequences for safety, warranty and correct operation.

DISCLAIMER

Designs and specifications are subject to change without notice. All logos, brands and product names are trademarks or registered trademarks of their respective owners and are hereby recognised as such

RECYCLING

Our products are packaged in environmentally friendly materials that can be recycled, disposed of or destroyed without endangering the environment.



This symbol indicates that a product should not be thrown away with other household waste throughout the EU to prevent possible harm to the environment or human health by uncontrolled waste disposal. You are responsible for recycling in order to promote the sustainable reuse of raw materials.

COMPLIANCE



Monsieur Tricot complies with Low Voltage, EMC, Ecodesign and RoHS directives.

FCC WARNING

This device complies with part 15 of the FCC Rules. Operation is subject to the following two conditions: (1) this device must not cause harmful interference, and (2) the user must accept any interference received, including interference that may cause undesired operation. Any changes or modifications not expressly approved by the party responsible for compliance could void the user's authority to operate the equipment.

NOTE: This equipment has been tested and found to comply with the limits for a Class B digital device, pursuant to Part 15 of the FCC Rules. These limits are designed to provide reasonable protection against harmful interference in a residential installation. This equipment generates, uses and can radiate radio frequency energy and, if not installed and used in accordance with the instructions, may cause harmful interference to radio communications. However, there is no guarantee that interference will not occur in a particular installation.

If this equipment does cause interference to radio or television reception, which can be determined by turning the equipment off and on, the user is encouraged to try to correct the interference by one or more of the following measures:

- Reorient or relocate the receiving antenna.
- Increase the separation between the equipment and receiver.
- Connect the equipment to an outlet on a different circuit from the receiver.
- Consult the dealer or an experienced radio/TV technician for help.

To maintain compliance with the FCC's RF Exposure guidelines, This equipment should be installed and operated with minimum distance of 20cm between the source of interference (in this case Bluetooth) and your body.

WARNING IC

This device complies with Industry Canada's licence-exempt RSSs. Operation is subject to the following two conditions:

- (1) This device must not cause interference; and
- (2) This user must accept any interference, including interference that may cause undesired operation of the device.

To maintain compliance with RF exposure guidelines, this equipment should be installed and operated with a minimum distance of 20cm between the lamp and your body.

Le présent appareil est conforme aux CNR d'Industrie Canada applicables aux appareils radio exempts de licence. L'exploitation est autorisée aux deux conditions suivantes:

- (1) l'appareil ne doit pas produire de brouillage, et
- (2) l'utilisateur de l'appareil doit accepter tout brouillage radioélectrique subi, même si le brouillage est susceptible d'en compromettre le fonctionnement.

Pour maintenir la conformité aux directives d'exposition aux radiofréquences, cet équipement doit être installé et utilisé avec une distance minimale de 20 cm entre le radiateur et votre corps.

Hanging lamps

Monsieur Tricot

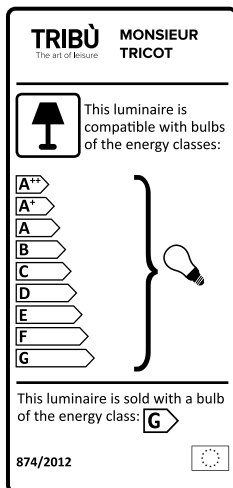

PRODUCT OVERVIEW HANGING LAMPS

PARTS LIST

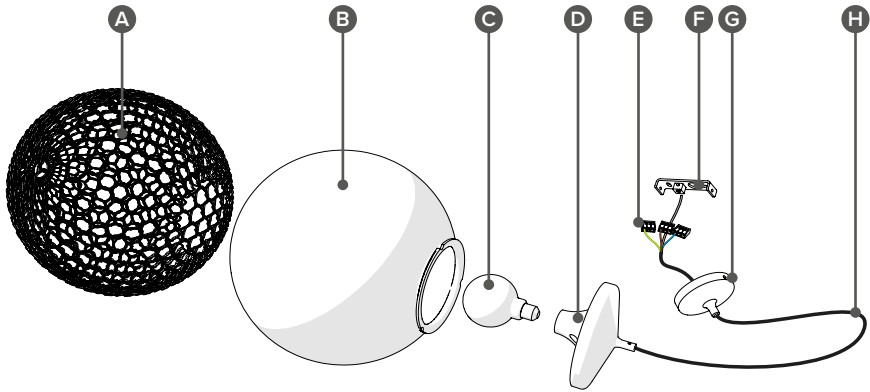

- A** Removable cover
- B** Sphere
- C** LED light (replaceable)
- D** Fitting

- E** Splicing connector
- F** Mounting bracket
- G** Ceiling canopy
- H** 4-wire cable, 5 meter

SPECIFICATIONS

Light source	LED light (replaceable)
Color temperature	2.200 K
Fitting	E27
Voltage	220-240V
Wattage	2.5W
Light source ifetime	30.000
On/off cycles	10.000
Luminous flux	240 Lumen
Colour rendering index	Ra. 80
Energy class	F
Installation	5 meter cable, mounting bracket, ceiling canopy and wire connector clamps included
Control	Have a local professional install a switch
Dimming	Have a local professional select a light source that fits the installation and is equipped with a dimmer.

INSTALLATION

CHECK THE CONTENTS OF THE PACKAGE

Check if all parts from the parts list are present and that no damage is visible on the parts. If parts are missing or damaged, please contact your local Tribù dealer.

INSTALLING THE LAMP

- ⚠ Always switch off the power before starting installation or maintenance work.
- ⚠ Installation must be done by a qualified electrician.
- ⚠ Installing the lamp requires two people.

To hang the lamp at the desired height:

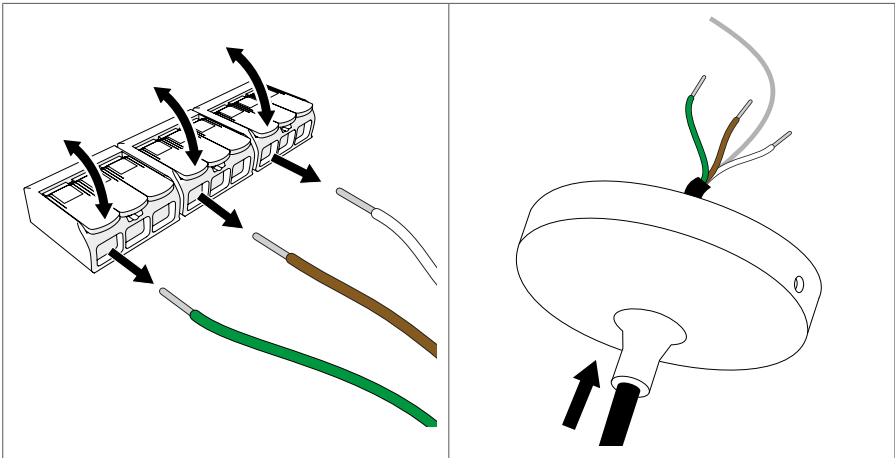

1. Remove the wires from the splicing connectors.
2. Route the cable through the canopy.

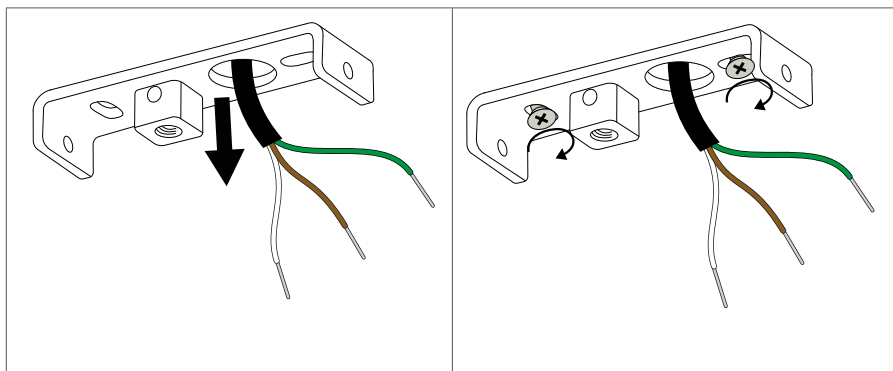

3. Guide the cables coming from the ceiling trough the designated hole in the mounting bracket.
4. Secure the mounting bracket to the ceiling with 2 screws.

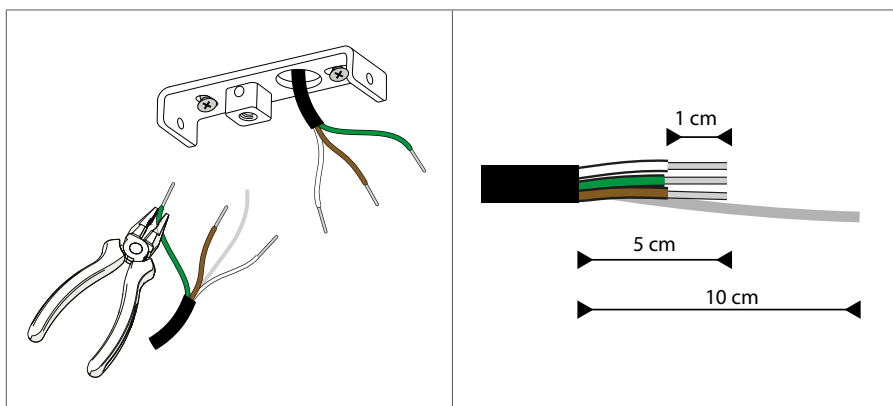

5. Cut the exposed cable to the desired length - minimum 10cm.
 6. Remove 10 cm of the black cover.
 7. Shorten the electric wires to 5 cm and strip 1 cm.
- ⚠ Do not shorten the metal wire.

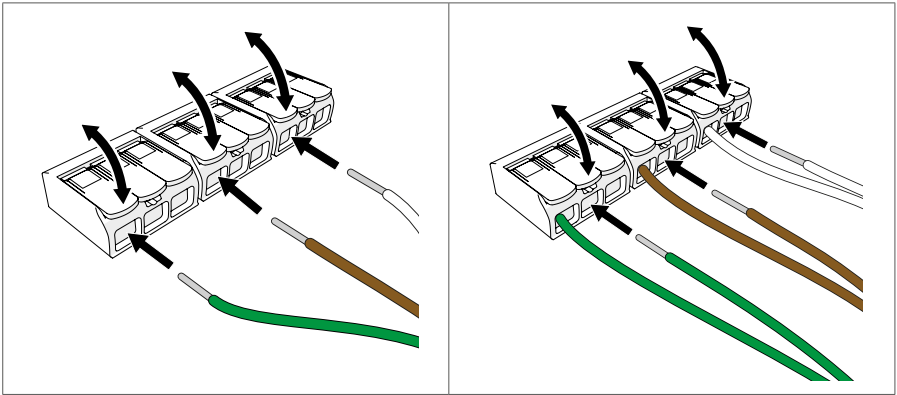

8. Insert the cables from the lamp into the splicing connectors.
9. Connect the wires coming from the ceiling and the cables from the lamp with the splicing connectors.

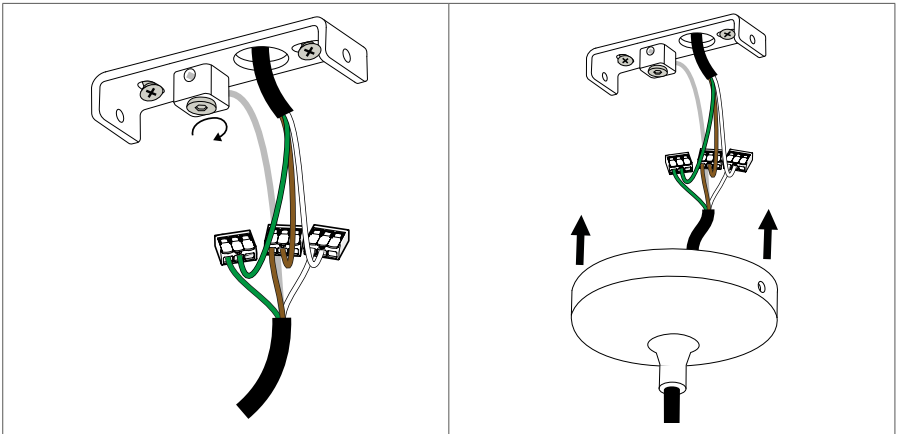

10. Secure the steel cable by inserting it in the designated hole. Secure it by tightening the screw.
11. Slide the canopy over the mounting bracket.

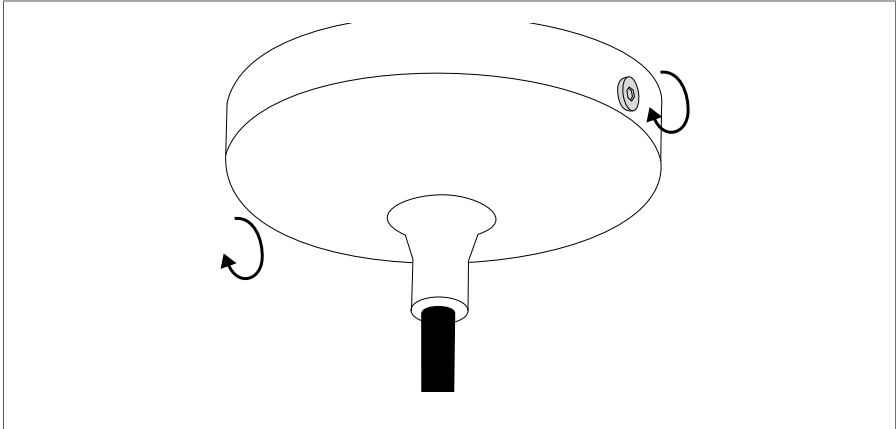

12. Secure the canopy by tightening the 2 bolts.

MAINTENANCE

REPLACING THE LED LIGHT BULB

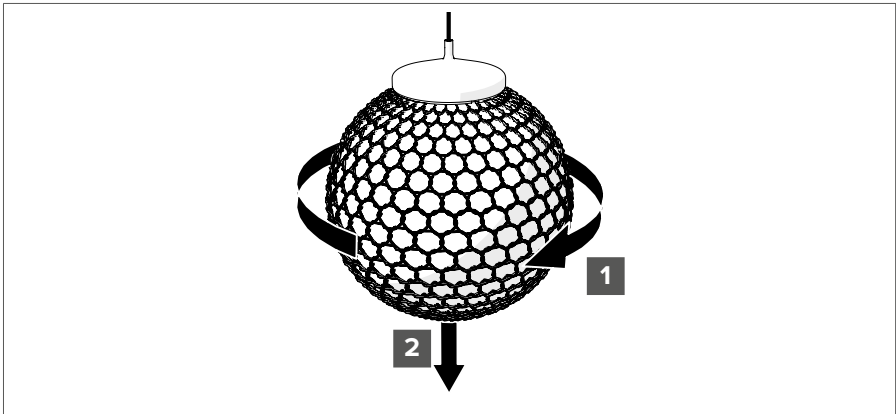

- ⚠ Always switch off the power before starting installation or maintenance work.
1. Turn the sphere clockwise until it is free of the bayonet catch.
 2. Remove the sphere.

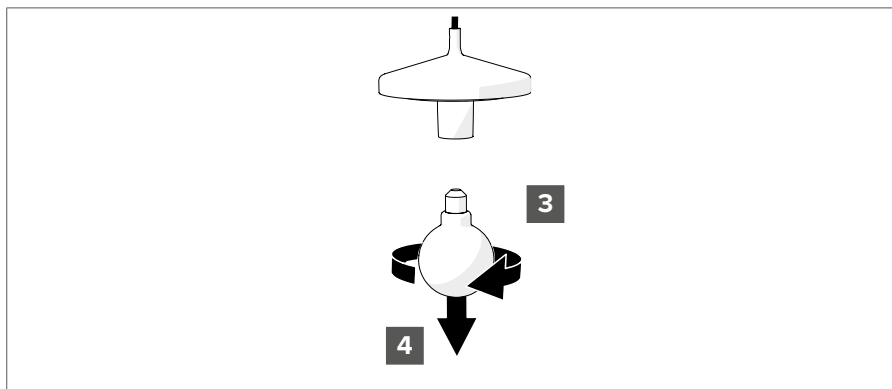

3. Turn the LED light clockwise.
4. Remove the LED light.

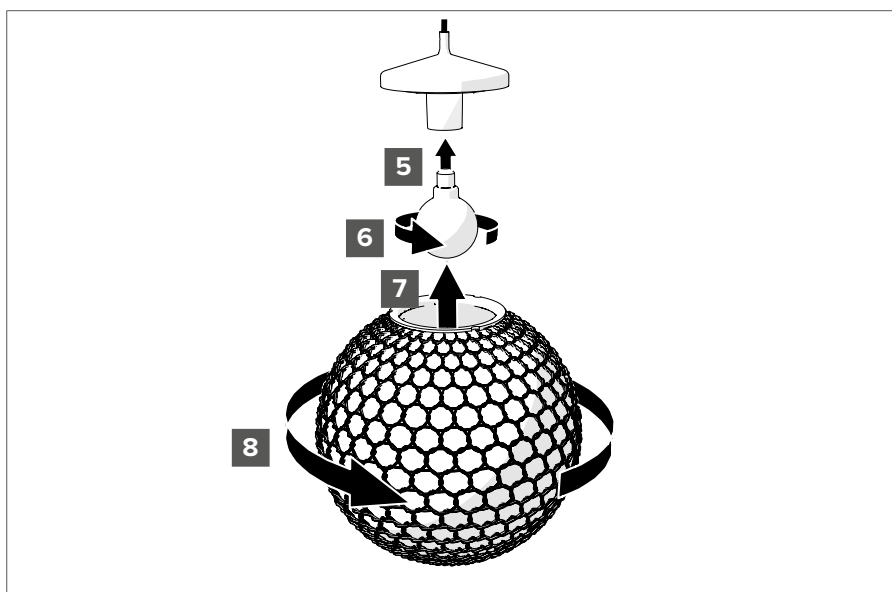

5. Place the new LED light in the socket.
6. Turn the LED light counterclockwise.
7. Place the sphere in the bayonet catch.
8. Turn the sphere counterclockwise until it is fastened.
9. Switch on the power and test whether the lamp is functioning properly.

CLEANING THE COVER

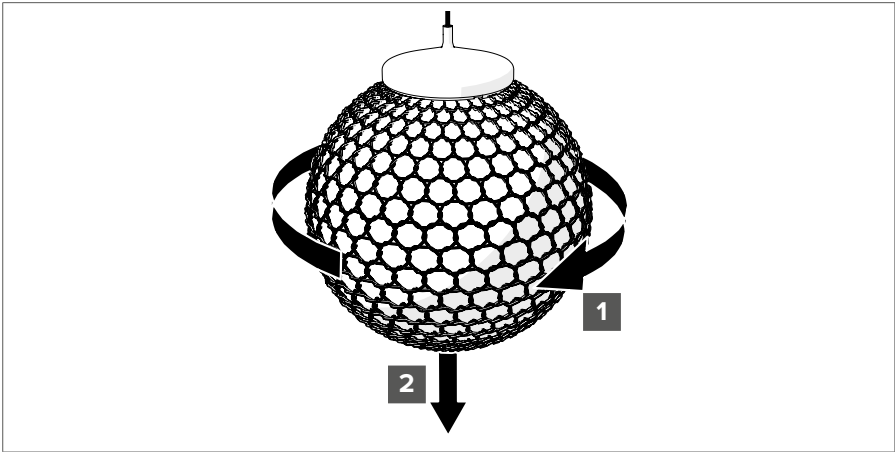

⚠ Always switch off the power before starting installation or maintenance work.

1. Turn the sphere clockwise until it is free of the bayonet catch.
2. Remove the sphere.

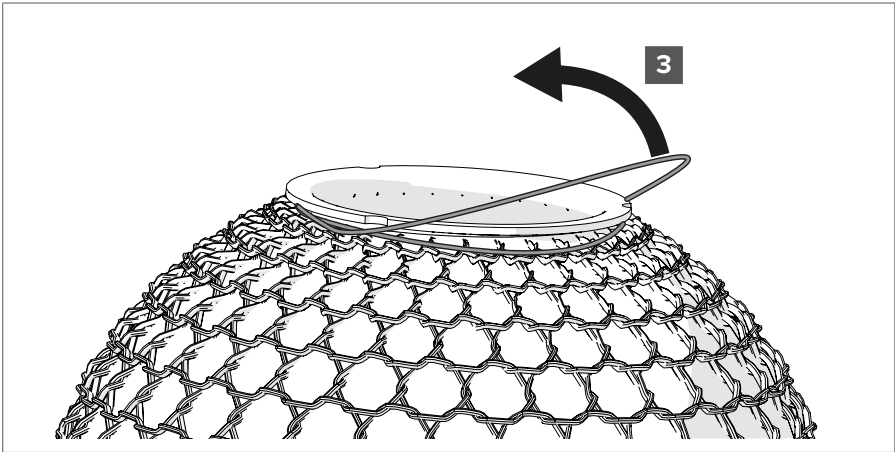

3. Loosen the elastic band of the removable cover.

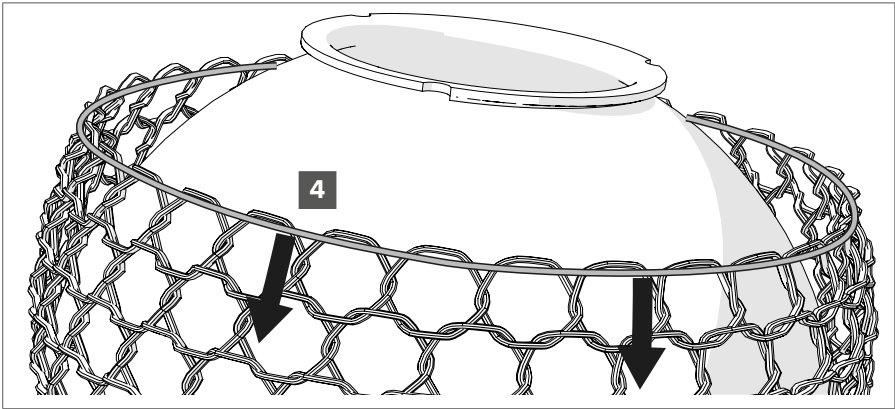

4. Pull the cover off the sphere.
5. Wash at 40°C (104°F) with a pH-neutral washing agent.
- ⚠ Do not tumble dry the cover.
6. Use a clean, microfibre cloth, lukewarm/warm water and a pH-neutral washing agent to clean the sphere.

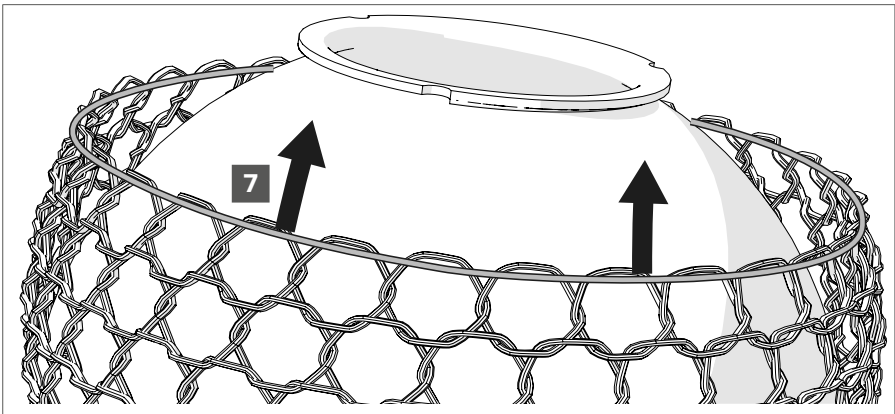

7. Pull the cover back over the sphere.

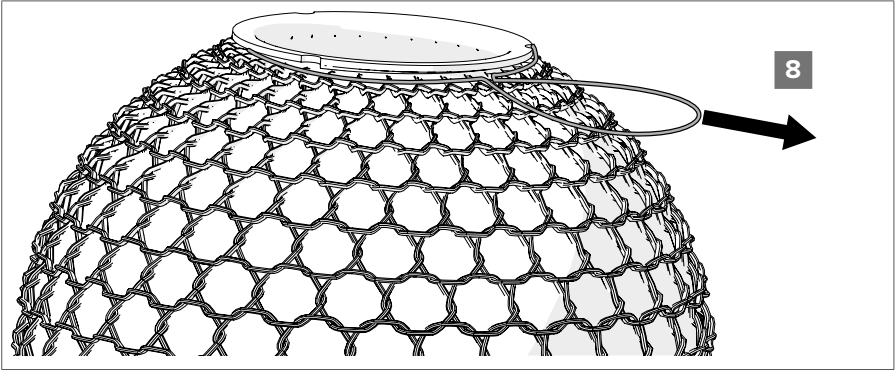

8. Tighten the elastic band to create a loop.

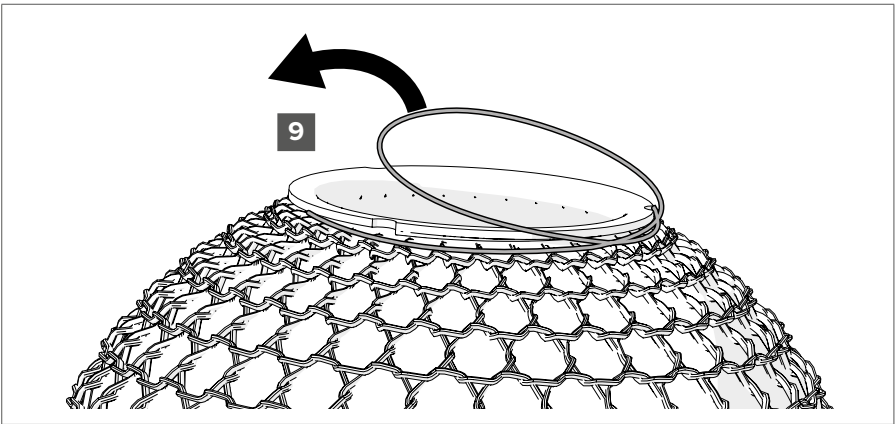

9. Twist and pull the loop over the rim of the sphere.

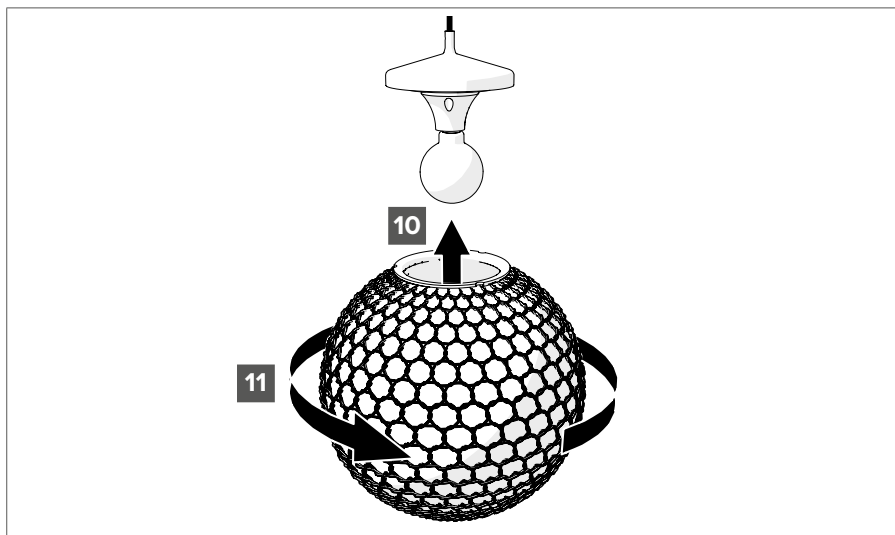

10. Place the sphere in the bayonet catch.
11. Turn the sphere counterclockwise until it is fastened.
12. Switch on the power and test whether the lamp is functioning properly.

NOTES



Produced by:

TRIBÙ

Oude Heidestraat 72

3740 Bilzen

België

www.tribu.com